



**REPORT OF GROUP DIRECTOR, NEIGHBOURHOODS AND HOUSING**

<b>LICENSING SUB-COMMITTEE:</b> 28/06/2016	<b>Classification</b> DECISION	<b>Enclosure</b>
<b>Application for a Premises Licence</b>  Round Chapel Arts Centre, 1d Glenarm Road, E5 0LY	<b>Ward(s) affected</b>  Leabridge	

**1. SUMMARY**

<b>Applicant(s)</b> Hackney Historic Building Trust	<b>In SPA</b> Not Applicable																
<b>Date of Application</b> 16/03/2016	<b>Period of Application</b> Permanent																
<b>Proposed licensable activity</b> Plays Films Indoor Sporting Events Boxing or Wrestling Entertainment Live Music Recorded Music Performance of Dance Other Entertainment Similar to Live or Rec Music or Dance Performance Late Night Refreshment Supply of Alcohol (On Premises)																	
<b>Proposed hours of licensable activities</b>  <table> <tr> <td data-bbox="193 1451 798 1489"><b>Plays</b></td> <td data-bbox="798 1451 1415 1489"><b>Standard Hours:</b></td> </tr> <tr> <td data-bbox="193 1489 798 1527"></td> <td data-bbox="798 1489 1415 1527">Mon 12:00-23:00</td> </tr> <tr> <td data-bbox="193 1527 798 1565"><b>INDOOR:</b></td> <td data-bbox="798 1527 1415 1565">Tue 12:00-23:00</td> </tr> <tr> <td data-bbox="193 1565 798 1603"></td> <td data-bbox="798 1565 1415 1603">Wed 12:00-23:00</td> </tr> <tr> <td data-bbox="193 1603 798 1641">Indoors</td> <td data-bbox="798 1603 1415 1641">Thu 12:00-23:00</td> </tr> <tr> <td data-bbox="193 1641 798 1680"></td> <td data-bbox="798 1641 1415 1680">Fri 12:00-00:00</td> </tr> <tr> <td data-bbox="193 1680 798 1718"></td> <td data-bbox="798 1680 1415 1718">Sat 12:00-00:00</td> </tr> <tr> <td data-bbox="193 1718 798 1756"></td> <td data-bbox="798 1718 1415 1756">Sun 12:00-23:00</td> </tr> </table>		<b>Plays</b>	<b>Standard Hours:</b>		Mon 12:00-23:00	<b>INDOOR:</b>	Tue 12:00-23:00		Wed 12:00-23:00	Indoors	Thu 12:00-23:00		Fri 12:00-00:00		Sat 12:00-00:00		Sun 12:00-23:00
<b>Plays</b>	<b>Standard Hours:</b>																
	Mon 12:00-23:00																
<b>INDOOR:</b>	Tue 12:00-23:00																
	Wed 12:00-23:00																
Indoors	Thu 12:00-23:00																
	Fri 12:00-00:00																
	Sat 12:00-00:00																
	Sun 12:00-23:00																
<table> <tr> <td data-bbox="193 1794 798 1832"><b>Films</b></td> <td data-bbox="798 1794 1415 1832"><b>Standard Hours:</b></td> </tr> <tr> <td data-bbox="193 1832 798 1870"></td> <td data-bbox="798 1832 1415 1870">Mon 12:00-23:00</td> </tr> <tr> <td data-bbox="193 1870 798 1908"><b>INDOOR:</b></td> <td data-bbox="798 1870 1415 1908">Tue 12:00-23:00</td> </tr> <tr> <td data-bbox="193 1908 798 1946"></td> <td data-bbox="798 1908 1415 1946">Wed 12:00-23:00</td> </tr> <tr> <td data-bbox="193 1946 798 1984">Indoors</td> <td data-bbox="798 1946 1415 1984">Thu 12:00-23:00</td> </tr> <tr> <td data-bbox="193 1984 798 2022"></td> <td data-bbox="798 1984 1415 2022">Fri 12:00-00:00</td> </tr> <tr> <td data-bbox="193 2022 798 2060"></td> <td data-bbox="798 2022 1415 2060">Sat 12:00-00:00</td> </tr> <tr> <td data-bbox="193 2060 798 2083"></td> <td data-bbox="798 2060 1415 2083">Sun 12:00-23:00</td> </tr> </table>		<b>Films</b>	<b>Standard Hours:</b>		Mon 12:00-23:00	<b>INDOOR:</b>	Tue 12:00-23:00		Wed 12:00-23:00	Indoors	Thu 12:00-23:00		Fri 12:00-00:00		Sat 12:00-00:00		Sun 12:00-23:00
<b>Films</b>	<b>Standard Hours:</b>																
	Mon 12:00-23:00																
<b>INDOOR:</b>	Tue 12:00-23:00																
	Wed 12:00-23:00																
Indoors	Thu 12:00-23:00																
	Fri 12:00-00:00																
	Sat 12:00-00:00																
	Sun 12:00-23:00																

<p><b>Indoor Sporting Events</b></p> <p><b>INDOOR:</b></p>	<p><b>Standard Hours:</b>  Mon 12:00-23:00  Tue 12:00-23:00  Wed 12:00-23:00  Thu 12:00-23:00  Fri 12:00-00:00  Sat 12:00-00:00  Sun 12:00-23:00</p>
<p><b>Boxing or Wrestling Entertainment</b></p> <p><b>INDOOR:</b></p> <p>Indoors</p>	<p><b>Standard Hours:</b>  Mon 12:00-23:00  Tue 12:00-23:00  Wed 12:00-23:00  Thu 12:00-23:00  Fri 12:00-00:00  Sat 12:00-00:00  Sun 12:00-23:00</p>
<p><b>Live Music</b></p> <p><b>INDOOR:</b></p> <p>Indoors</p>	<p><b>Standard Hours:</b>  Mon 12:00-23:00  Tue 12:00-23:00  Wed 12:00-23:00  Thu 12:00-23:00  Fri 12:00-00:00  Sat 12:00-00:00  Sun 12:00-23:00</p>
<p><b>Recorded Music</b></p> <p><b>INDOOR:</b></p> <p>Indoors</p>	<p><b>Standard Hours:</b>  Mon 12:00-23:00  Tue 12:00-23:00  Wed 12:00-23:00  Thu 12:00-23:00  Fri 12:00-00:00  Sat 12:00-00:00  Sun 12:00-23:00</p>
<p><b>Performance of Dance</b></p> <p><b>INDOOR:</b></p> <p>Indoors</p>	<p><b>Standard Hours:</b>  Mon 12:00-23:00  Tue 12:00-23:00  Wed 12:00-23:00  Thu 12:00-23:00  Fri 12:00-00:00  Sat 12:00-00:00  Sun 12:00-23:00</p>
<p><b>Other Entertainment Similar to Live or Rec Music or Dance Performance</b></p> <p><b>INDOOR:</b></p> <p>Indoors</p>	<p><b>Standard Hours:</b>  Mon 12:00-23:00  Tue 12:00-23:00  Wed 12:00-23:00  Thu 12:00-23:00  Fri 12:00-00:00  Sat 12:00-00:00  Sun 12:00-23:00</p>

<b>Late Night Refreshment</b>		<b>Standard Hours:</b> Fri 23:00-00:00 Sat 23:00-00:00
<b>INDOOR:</b>		
<b>Supply of Alcohol</b>		<b>Standard Hours:</b> Mon 12:00-23:00 Tue 12:00-23:00 Wed 12:00-23:00 Thu 12:00-23:00 Fri 12:00-00:00 Sat 12:00-00:00 Sun 12:00-23:00
<b>INDOOR:</b>		
<b>The opening hours of the premises</b>		
<b>INDOOR</b>		<b>Standard Hours:</b> Mon 12:00-23:00 Tue 12:00-23:00 Wed 12:00-23:00 Thu 12:00-23:00 Fri 12:00-00:00 Sat 10:00-00:00 Sun 10:00-23:00
<b>Capacity:</b> Not known		
<b>Policies Applicable</b>	LP3 (Operating Schedule), LP4 (Crime and Disorder), LP5 (Public Nuisance), LP6 (Protection of Children from Harm), LP8 (Public Safety),	
<b>List of Appendices</b>	A – Application for a premises licence and supporting documents B – Representations from responsible authorities C – Representations from other persons D – Location map	
<b>Relevant Representations</b>	<ul style="list-style-type: none"> <li>• Environmental Health Authority (Pollution and Environmental Enforcement)</li> <li>• Licensing Authority</li> <li>• Other Persons</li> </ul>	

## 2. APPLICATION

2.1 **Hackney Historic Building Trust** has made an application for a premises licence under the Licensing Act 2003:

- To supply alcohol for consumption **on** the premises
- Regulated entertainment
- Late night refreshment

2.2 The application is attached as Appendix A. The applicant has proposed measures that could be converted to conditions (see paragraph 8.1 below).

## 3. CURRENT STATUS / HISTORY

- 3.1 The premises are not currently licensed for any activity, although the annual Pigs Ear Beer Festival has in recent years obtained a 6 day time limited premises licence for sale of alcohol.
- 3.2 Temporary Event Notices have been submitted for the venue during the current calendar year as follows:

Start date	End date	Start time	End time
14/01/2016	14/01/2016	19.00	23.00
17/02/2016	17/02/2016	19.00	23.30
17/03/2016	17/03/2016	19.00	23.00
16/04/2016	16/04/2016	19.00	23.30
23/04/2016	23/04/2016	12.00	22.00
01/05/2016	01/05/2016	10.00	23.00

#### 4. REPRESENTATIONS: RESPONSIBLE AUTHORITIES

From	Details
Environmental Health Authority (Pollution)	No representation received
Environmental Health Authority (Environmental Enforcement) (Appendix B1)	Representation received on the grounds of the prevention of public nuisance
Environmental Health Authority (Health & Safety)	Have confirmed no representation on this application
Weights and Measures (Trading Standards)	Have confirmed no representation on this application
Planning Authority	Have confirmed no representation on this application
Area Child Protection Officer	No representation received
Fire Authority	Have confirmed no representation on this application
Police	Representation has been withdrawn following acceptance of proposed conditions..
Licensing Authority (Appendix B2)	Representation received on the grounds of The Prevention of Public Nuisance,
Health Authority	Have confirmed no representation on this application

#### 5. REPRESENTATIONS: OTHER PERSONS

From	Details
Representation received from and on behalf of local residents. (Appendices C1-C7)	7 representation received on the grounds of The Prevention of Crime and Disorder, Public Safety, Prevention of Public Nuisance, The Protection of Children from Harm,

#### 6. GUIDANCE CONSIDERATIONS

- 6.1 The Licensing Authority is required to have regard to any guidance issued by the Secretary of State under the Licensing Act 2003.

## **7. POLICY CONSIDERATIONS**

- 7.1 Licensing Sub-Committee is required to have regard to the London Borough of Hackney's Statement of Licensing Policy ("the Policy") adopted by the Licensing Authority.
- 7.2 The Policy applies to applications where relevant representations have been made. With regard to this application policies LP3 (Operating Schedule), LP4 (Crime and Disorder), LP5 (Public Nuisance), LP6 (Protection of Children from Harm), LP8 (Public Safety), are relevant.

## **8. OFFICER OBSERVATIONS**

- 8.1 If the Sub-Committee is minded to approve the application, the following conditions should be applied the licence:

### **Supply of Alcohol (On/Both)**

1. No supply of alcohol may be made under the premises licence:
  - (a) At a time when there is no designated premises supervisor in respect of the premises licence.
  - (b) At a time when the designated premises supervisor does not hold a personal licence or his personal licence is suspended.
2. Every supply of alcohol under the premises licence must be made or authorised by a person who holds a personal licence.
3. (1) The responsible person must ensure that staff on relevant premises do not carry out, arrange or participate in any irresponsible promotions in relation to the premises.  
(2) In this paragraph, an irresponsible promotion means any one or more of the following activities, or substantially similar activities, carried on for the purpose of encouraging the sale or supply of alcohol for consumption on the premises -
  - (a) games or other activities which require or encourage, or are designed to require or encourage, individuals to;
    - (i) drink a quantity of alcohol within a time limit (other than to drink alcohol sold or supplied on the premises before the cessation of the period in which the responsible person is authorised to sell or supply alcohol), or
    - (ii) drink as much alcohol as possible (whether within a time limit or otherwise);
  - (b) provision of unlimited or unspecified quantities of alcohol free or for a fixed or discounted fee to the public or to a group defined by a particular characteristic in a manner which carries a significant risk of undermining a licensing objective;
  - (c) provision of free or discounted alcohol or any other thing as a prize to encourage or reward the purchase and consumption of alcohol over a period of 24 hours or less in a manner which carries a significant risk of undermining a licensing objective;
  - (d) selling or supplying alcohol in association with promotional posters or flyers on, or in the vicinity of, the premises which can reasonably be

considered to condone, encourage or glamorise anti-social behaviour or to refer to the effects of drunkenness in any favourable manner.

(e) dispensing alcohol directly by one person into the mouth of another (other than where that other person is unable to drink without assistance by reason of a disability).

4. The responsible person must ensure that free potable water is provided on request to customers where it is reasonably available.

5.5.1. The premises licence holder or club premises certificate holder must ensure that an age verification policy is adopted in respect of the premises in relation to the sales or supply of alcohol.

5.2 The designated premises supervisor in relation to the premises licences must ensure that the supply of alcohol at the premises is carried on in accordance with the age verification policy.

5.3. The policy must require individuals who appear to the responsible person to be under 18 years of age (or such older age as may be specified in the policy) to produce on request, before being served alcohol, identification bearing their photograph, date of birth and either:-

- (a) a holographic mark or
- (b) an ultraviolet feature

6. The responsible person must ensure that:

a) where any of the following alcoholic drinks is sold or supplied for consumption on the premises (other than alcoholic drinks sold or supplied having been made up in advance ready for sale or supply in a securely closed container) it is available to customers in the following measures:

- beer or cider: 1/2 pint;
- gin, rum, vodka or whisky: 25ml or 35ml; and
- still wine in a glass: 125ml; and

b) these measures are displayed in a menu, price list or other printed material which is available to customers on the premises; and

c) where a customer does not in relation to a sale of alcohol specify the quantity of alcohol to be sold, the customer is made aware that these measures are available.

#### Minimum Drinks Pricing

7. 7.1 A relevant person shall ensure that no alcohol is sold or supplied for consumption on or off the premises for a price which is less than the permitted price.

7.2 For the purposes of the condition set out in paragraph 7.1 above -

(a) "duty" is to be construed in accordance with the Alcoholic Liquor Duties Act 1979;

(b) "permitted price" is the price found by applying the formula -  $P = D + (D \times V)$

Where -

(i) P is the permitted price,

(ii) D is the rate of duty chargeable in relation to the alcohol as

if the duty were charged on the date of the sale or supply of the alcohol, and

(iii) V is the rate of value added tax chargeable in relation to the alcohol as if the value added tax were charged on the date of the sale or supply of the alcohol;

(c) "relevant person" means, in relation to premises in respect of which there is in force a premises licence -

- (i) the holder of the premises licence,
- (ii) the designated premises supervisor (if any) in respect of such a licence, or
- (iii) the personal licence holder who makes or authorises a supply of alcohol under such a licence;
- (d) “relevant person” means, in relation to premises in respect of which there is in force a club premises certificate, any member or officer of the club present on the premises in a capacity which enables the member or officer to prevent the supply in question; and
- (e) “value added tax” means value added tax charged in accordance with the Value Added Tax Act 1994.

7.3 Where the permitted price given by Paragraph 7.2(b) above would (apart from this paragraph) not be a whole number of pennies, the price given by that sub-paragraph shall be taken to be the price actually given by that sub-paragraph rounded up to the nearest penny.

7.4 (1) Sub-paragraph 7.4(2) below applies where the permitted price given by Paragraph 7.2(b) above on a day (“the first day”) would be different from the permitted price on the next day (“the second day”) as a result of a change to the rate of duty or value added tax.

(2) The permitted price which would apply on the first day applies to sales or supplies of alcohol which take place before the expiry of the period of 14 days beginning on the second day.

### **Door Supervision**

8. Each individual who is to carry out a security activity at the premises must be licensed by the Security Industry Authority.

### **Conditions derived from operating schedule**

9. Any provision of alcohol at events shall be ancillary to the event itself. Hirers must show that they will break-even or make a profit without the sale of alcohol and that the provision of alcohol is supplementary to the exhibition, performance or event programmed.

10. Hirers are inducted at the commencement of every event with regards to potential risk, health and safety policies, the fire management plan and evacuation procedures. Detailed risk assessments are carried out prior to events in conjunction with the hirer. Bar operators are reminded of their legal duties and the required duty of care they have in respect of the attending public.

11. Children are only admitted to the building accompanied by an adult for matinee performances. Children are not permitted when alcohol is being served unless they are babies in arms

### **Conditions derived from Responsible Authority representations**

12. The premises shall maintain a comprehensive CCTV system as per the minimum requirements of a Metropolitan Police Crime Prevention Officer. All public areas, entry and exit points will be covered enabling frontal identification of every person entering in any light condition. The CCTV system shall continually record whilst the premises is open for licensable activities and during all times when customers remain on the premises. All recordings shall be stored for a minimum period of 31 days with date and time stamping. Recordings shall be made available immediately upon the request of Police or authorised officer.

13. A staff member from the premises who is conversant with the operation of the CCTV system shall be on the premises at all times when the premises are open to the public. This staff member shall be able to show Police or an authorised officer of Hackney Borough Council recent data or footage with the absolute minimum of delay when requested.

14. An incident log shall be kept at the premises, and made available immediately to an authorised officer of the Hackney Borough Council or the Police, which will record the following:

- a. all crimes reported to the venue
- b. any complaints received
- c. any incidents of disorder
- d. any faults in the CCTV system
- e. any refusal of the sale of alcohol
- f. any visit by a relevant authority or emergency service.

15. All instances of crime or disorder to be reported by the designated premises supervisor or responsible member of staff to an agreed police contact point, as agreed with the Police.

16. Where the sale or supply of alcohol is taking place employees of the premises must request sight of evidence of the age of any person appearing to be under 25 years of age (Challenge 25). Such evidence may include a driving licence or passport.

17. There shall be no glass, drinks or open containers taken outside of the premises at any time.

18. The premises will display and maintain appropriate signage advising customers of the contact details of the Designated Premises Supervisor.

19. All staff will be given refresher training every twelve months on the legislation relating to the sales of alcohol to underage persons and drunken persons. Written records of this training shall be kept on the premises and produced to police or other authorised officer upon request.

20. SIA registered door supervisors to be employed on an operational risk assessment basis. All door supervisors shall enter their full details in the premises daily register at the commencement of their work. They shall record their full name, home address and contact telephone number, their SIA registration number, and the time they commence and conclude working. If the door supervisor was provided by an agency the name, registered business address and contact telephone number will also be recorded. This register will be made available to police or authorised officer immediately upon request.

21. There shall be a written dispersal policy at the venue. This shall be kept on the premises and shall be produced to a police officer or other authorised officer upon request.

## **9. REASONS FOR OFFICER OBSERVATIONS**



9.1 Conditions 9 to 11 above are derived from the applicant's operating schedule. Conditions 12 to 21 have been proposed by the police and have been accepted by the applicant.

## 10. LEGAL COMMENTS

10.1 The Council has a duty as a Licensing Authority under the Licensing Act 2003 to carry out its functions with a view to promoting the following 4 licensing objectives;

- The Prevention of Crime and Disorder
- Public Safety
- Prevention of Public Nuisance
- The Protection of Children from Harm

10.2 It should be noted that each of the licensing objectives have equal importance and are the only grounds upon which a relevant representation can be made and for which an application can be refused or terms and conditions attached to a licence.

## 11. HUMAN RIGHTS ACT 1998 IMPLICATIONS

11.1 There are implications to;

- **Article 6** – Right to a fair hearing
- **Article 14** – Not to discriminate
- Balancing: **Article 1**- Peaceful enjoyment of their possession (i.e. a licence is defined as being a possession) with **Article 8** – Right of Privacy (i.e. respect private & family life) to achieve a proportionate decision having regard to the protection of an individuals rights against the interests of the community at large.

## 12. MEMBERS DECISION MAKING

### A. Option 1

**That the application be refused**

### B. Option 2

**That the application be approved, together with any conditions or restrictions which Members consider necessary for the promotion of the Licensing objectives.**

## 13. CONCLUSION

13.1 That Members decide on the application under the Licensing Act 2003.

<b>Group Director, Neighbourhoods and Housing</b>	Kim Wright
<b>Lead Officer (holder of original copy):</b>	Mike Smith Principal Licensing Officer Licensing Service 2 Hillman Street E8 1FB Telephone: 020 8356 4973

## LIST OF BACKGROUND PAPERS RELATING TO THIS REPORT

The following document(s) has been relied upon in the preparation of the report.

Description of document	Location
<b>Office File:</b> Round Chapel Arts Centre, 1d Glenarm Road, E5 0LY	Licensing Service 2 Hillman Street London E8 1FB

### Printed matter

Licensing Act 2003

LBH Statement of Licensing Policy

SR: 485255

LOR 13/14/2014 APPENDIX A

<b>Hackney</b>  LA01	<b>Application for a premises licence to be granted under the Licensing Act 2003</b>
----------------------------	--

**PLEASE READ THE FOLLOWING INSTRUCTIONS FIRST**

Before completing this form please read the guidance notes at the end of the form. If you are completing this form by hand please write legibly in block capitals. In all cases ensure that your answers are inside the boxes and written in black ink. Use additional sheets if necessary.

You may wish to keep a copy of the completed form for your records.

I/We Hackney Historic Buildings Trust  
(Insert name(s) of applicant)

apply for a premises licence under section 17 of the Licensing Act 2003 for the premises described in Part 1 below (the premises) and I/we are making this application to you as the relevant licensing authority in accordance with section 12 of the Licensing Act 2003

**Part 1 – Premises Details**

<b>Postal address of premises or, if none, ordnance survey map reference or description</b> The Round Chapel ROUND CHAPEL ARTS CENTRE 1D GLENARM ROAD HACKNEY LONDON			
<b>Post town</b>	LONDON	<b>Post code</b>	E5 0LY
<b>Telephone number at premises (if any)</b>	[REDACTED]		
<b>Non-domestic rateable value of premises</b>	£23750		

**Part 2 - Applicant Details**

Please state whether you are applying for a premises licence as  
Please tick yes

a)	an individual or individuals *		please complete section (A)
b)	a person other than an individual *		

	i.	as a limited company	..	please complete section (B)
	ii.	as a partnership	..	please complete section (B)
	iii	as an unincorporated association or	..	please complete section (B)
	iv	other (for example a statutory corporation)	..	please complete section (B)
c)		a recognised club	..	please complete section (B)
d)		a charity	<input checked="" type="checkbox"/>	please complete section (B)
e)		the proprietor of an educational establishment	..	please complete section (B)
f)		a health service body	..	please complete section (B)
g)		a person who is registered under Part 2 of the Care Standards Act 2000 (c14) in respect of an independent hospital in Wales	..	please complete section (B)
ga		a person who is registered under Chapter 2 of Part 1 of the Health and Social Care Act 2008 (within the meaning of that Part) in an independent hospital in England		please complete section (B)

h)	the chief officer of police of a police force in England and Wales		please complete section (B)
----	--	--	-----------------------------

\* If you are applying as a person described in (a) or (b) please confirm:

Please tick yes

- I am carrying on or proposing to carry on a business which involves the use of the premises for licensable activities; or
- I am making the application pursuant to a
  - statutory function or   a function discharged by virtue of Her Majesty's prerogative

**(A) INDIVIDUAL APPLICANTS (fill in as applicable)**

<b>Title</b> Mr			
<b>Surname</b>		<b>First names</b>	
<b>I am 18 years old or over</b>			Please tick yes
<b>Current postal address if different from premises address</b>		UK-England	
<b>Post Town</b>		<b>Postcode</b>	
<b>Daytime contact telephone number</b>			
<b>E-mail address (optional)</b>			

**SECOND INDIVIDUAL APPLICANT (if applicable)**

<b>Title</b> Mr	
<b>Surname</b>	<b>First names</b>
<b>I am 18 years old or over</b>	
Please tick yes	

<b>Current postal address if different from premises address</b>		UK-England	
<b>Post Town</b>		<b>Postcode</b>	
<b>Daytime contact telephone number</b>			
<b>E-mail address (optional)</b>			

**(B) OTHER APPLICANTS**

Please provide name and registered address of applicant in full. Where appropriate please give any registered number. In the case of a partnership or other joint venture (other than a body corporate), please give the name and address of each party concerned

<b>Name</b> Hackney Historic Buildings Trust
<b>Address</b> 1d Glenarm Road Hackney London E5 0LY
<b>Registered number (where applicable)</b> Registered Charity 291468 Company Number 01879857
<b>Description of applicant (for example, partnership, company, unincorporated association)</b> Registered Charity Company Limited by Guarantee
<b>Telephone number (if any)</b> 0208 [REDACTED]
<b>E-mail address (optional)</b> [REDACTED]

**Part 3 Operating Schedule**

When do you want the premises licence to start?	02-05-2016
---	------------

If you wish the licence to be valid only for a limited period, when do you want to end?

it

Please give a general description of the premises (please read guidance note 1)

	Provision of regulated entertainment	Please tick any that apply
a)	plays (if ticking yes, fill in box A)	<input checked="" type="checkbox"/>
b)	films (if ticking yes, fill in box B) <input type="checkbox"/> <input type="checkbox"/>	<input checked="" type="checkbox"/>
c)	indoor sporting events (optional, fill in box C)	<input checked="" type="checkbox"/>
d)	boxing or wrestling entertainment (if ticking yes, fill in box D)	<input checked="" type="checkbox"/>
e)	live music (optional, fill in box E) <input type="checkbox"/>	<input checked="" type="checkbox"/>
f)	recorded music (if ticking yes, fill in box F)	<input checked="" type="checkbox"/>
g)	performances of dance (optional, fill in box G)	<input checked="" type="checkbox"/>

h) anything of a similar description to that falling within (e), (f) or (g) (if ticking yes, fill in box H)	<input checked="" type="checkbox"/>
<b>Provision of late night refreshment</b> (if ticking yes, fill in box L)	<input checked="" type="checkbox"/>
<b>Supply of alcohol</b> (if ticking yes, fill in box J)	<input checked="" type="checkbox"/>

A former church building with a ground floor area of approximately 500m2 with balcony. The building is hired to clients for weddings and festivals and occasional ticketed concerts live performance and film shows.

If 5,000 or more people are expected to attend the premises at any one time, please state the number expected to attend.	
--	--

What licensable activities do you intend to carry on from the premises?

(Please see sections 1 and 14 of the Licensing Act 2003 and Schedules 1 and 2 to the Licensing Act 2003)

**Complete boxes K, L and M (optional)**

**A**

Plays Standard days and timings (please read guidance note 6)			<u>Will the performance of a play take place indoors or outdoors or both – please tick</u> (please read guidance note 2)	Indoors	<input checked="" type="checkbox"/>
Day	Start	Finish		Outdoors	
Mon	12:00	23:00	<b><u>Please give further details here</u></b> (please read guidance note 3) These hours are requested to allow hirers the potential to operate within these times	Both	
Tue	12:00	23:00			
Wed	12:00	23:00	<b><u>State any seasonal variations for performing plays</u></b> (please read guidance note 4)		
Thur	12:00	23:00			



			<p><b><u>Non standard timings. Where you intend to use the premises for the performance of plays at different times to those listed in the column on the left, please list (please read guidance note 5)</u></b></p>
Fri	12:00	00:00	
Sat	12:00	00:00	
Sun	12:00	23:00	

**B**

Films Standard days and timings (please read guidance note 6)			<p><b><u>Will the exhibition of films take place indoors or outdoors or both – please tick (please read guidance note 2)</u></b></p>	Indoors	<input checked="" type="checkbox"/>
Day	Start	Finish		Outdoors	<input type="checkbox"/>
				Both	<input type="checkbox"/>
Mon	12:00	23:00	<p><b><u>Please give further details here (please read guidance note 3)</u></b> These hours are requested to allow hirers the potential to operate within these times</p>		
Tue	12:00	23:00			
Wed	12:00	23:00	<p><b><u>State any seasonal variations for the exhibition of films (please read guidance note 4)</u></b></p>		
Thur	12:00	23:00			
Fri	12:00	00:00	<p><b><u>Non standard timings. Where you intend to use the premises for the exhibition of films at different times to those listed in the column on the left, please list (please read guidance note 5)</u></b></p>		
Sat	12:00	00:00			
Sun	12:00	23:00			

--	--	--

**C**

<b>Indoor sporting events</b> Standard days and timings (please read guidance note 6)			<b><u>Please give further details</u></b> (please read guidance note 3) These hours are requested to allow hirers the potential to operate within these times
Day	Start	Finish	
Mon	12:00	23:00	
Tue	12:00	23:00	<b><u>State any seasonal variations for indoor sporting events</u></b> (please read guidance note 4)
Wed	12:00	23:00	
Thur	12:00	23:00	<b><u>Non standard timings. Where you intend to use the premises for indoor sporting events at different times to those listed in the column on the left, please list</u></b> (please read guidance note 5)
Fri	12:00	00:00	
Sat	12:00	00:00	
Sun	12:00	23:00	

**D**

<b>Boxing or wrestling entertainments</b> Standard days and timings (please read guidance note 6)			<b><u>Will the boxing or wrestling entertainment take place indoors or outdoors or both – please tick</u></b> (please read guidance note 2)	Indoors	<input checked="" type="checkbox"/>
Day	Start	Finish		Outdoors	<input type="checkbox"/>
Mon	12:00	23.00	Both	<input type="checkbox"/>	

			<b>Please give further details here</b> (please read guidance note 3) These hours are requested to allow hirers the potential to operate within these times
Tue	12:00	23:00	
			<b>State any seasonal variations for boxing or wrestling entertainment</b> (please read guidance note 4)
Wed	12:00	23:00	
Thur	12:00	23:00	
			<b>Non standard timings. Where you intend to use the premises for boxing or wrestling entertainment at different times to those listed in the column on the left, please list</b> (please read guidance note 5)
Fri	12:00	00:00	
Sat	12:00	00:00	
Sun	12:00	23:00	

**E**

<b>Live music</b> Standard days and timings (please read guidance note 6)			<b>Will the performance of live music take place indoors or outdoors or both – please tick</b> (please read guidance note 2)	Indoors	<input checked="" type="checkbox"/>
				Outdoors	<input type="checkbox"/>
Day	Start	Finish		Both	<input type="checkbox"/>
			<b>Please give further details here</b> (please read guidance note 3) These hours are requested to allow hirers the potential to operate within these times		
Mon	12:00	23:00			
Tue	12:00	23:00			
Wed	12:00	23:00	<b>State any seasonal variations for the performance of live music</b> (please read guidance note 4)		
Thur	12:00	23:00			

Fri	12:00	00:00	<p><b><u>Non standard timings. Where you intend to use the premises for the performance of live music at different times to those listed in the column on the left, please list</u></b> (please read guidance note 5)</p> <p>There may be a possibility for music festival events to require an earlier start time but no earlier than 11.00am</p>
Sat	12:00	00:00	
Sun	12:00	23:00	

**F**

<b>Recorded music</b> Standard days and timings (please read guidance note 6)			<p><b><u>Will the playing of recorded music take place indoors or outdoors or both – please tick</u></b> (please read guidance note 2)</p>	Indoors	<input checked="" type="checkbox"/>
				Outdoors	<input type="checkbox"/>
Day	Start	Finish		Both	<input type="checkbox"/>
Mon	12:00	23:00	<p><b><u>Please give further details here</u></b> (please read guidance note 3)</p> <p>These hours are requested to allow hirers the potential to operate within these times</p>		
Tue	12:00	23:00			
Wed	12:00	23:00	<p><b><u>State any seasonal variations for the playing of recorded music</u></b> (please read guidance note 4)</p>		
Thur	12:00	23:00			
Fri	12:00	00:00	<p><b><u>Non standard timings. Where you intend to use the premises for the playing of recorded music at different times to those listed in the column on the left, please list</u></b> (please read guidance note 5)</p>		
Sat	12:00	00:00			
Sun	12:00	23:00			

--	--

**G**

<b>Performances of dance</b> Standard days and timings (please read guidance note 6)			<b><u>Will the performance of dance take place indoors or outdoors or both – please tick</u></b> (please read guidance note 2)	Indoors	<input checked="" type="checkbox"/>
				Outdoors	<input type="checkbox"/>
				Both	<input type="checkbox"/>
Day	Start	Finish	<b><u>Please give further details here</u></b> (please read guidance note 3) These hours are requested to allow hirers the potential to operate within these times		
Mon	12:00	23:00			
Tue	12:00	23:00			
Wed	12:00	23:00			
			<b><u>State any seasonal variations for the performance of dance</u></b> (please read guidance note 4)		
Thur	12:00	23:00			
			<b><u>Non standard timings. Where you intend to use the premises for the performance of dance at different times to those listed in the column on the left, please list</u></b> (please read guidance note 5)		
Fri	12:00	00:00			
Sat	12:00	00:00			
Sun	12:00	23:00			

**H**

<b>Anything of a similar description to that falling within (e), (f) or (g)</b> Standard days and timings (please read guidance note 6)			<b><u>Please give a description of the type of entertainment you will be providing</u></b> Combined live performance, cabaret performances using multiple art forms and audio visuals.		
Day	Start	Finish		Indoors	<input checked="" type="checkbox"/>

Mon	12:00	23:00	<b><u>Will this entertainment take place indoors or outdoors or both – please tick</u></b> (please read guidance note 2)	Outdoors	
				Both	
Tue	12:00	23:00	<b><u>Please give further details here</u></b> (please read guidance note 3) These hours are requested to allow hirers the potential to operate within these times		
Wed	12:00	23:00			
Thur	12:00	23:00	<b><u>State any seasonal variations for entertainment of a similar description to that falling within (e), (f) or (g)</u></b> (please read guidance note 4)		
Fri	12:00	00:00			
Sat	12:00	00:00	<b><u>Non standard timings. Where you intend to use the premises for the entertainment of a similar description to that falling within (e), (f) or (g) at different times to those listed in the column on the left, please list</u></b> (please read guidance note 5)		
Sun	12:00	23:00			

**I**

<b>Late night refreshment</b> Standard days and timings (please read guidance note 6)			<b><u>Will the provision of late night refreshment take place indoors or outdoors or both – please tick</u></b> (please read guidance note 2)	Indoors	<input checked="" type="checkbox"/>
				Outdoors	
				Both	
Day	Start	Finish			
Mon			<b><u>Please give further details here</u></b> (please read guidance note 3) These hours are requested to allow hirers the potential to operate within these times		
Tue					



Wed			<b><u>State any seasonal variations for the provision of late night refreshment</u></b> (please read guidance note 4)
Thur			
Fri	12:00	00:00	<b><u>Non standard timings. Where you intend to use the premises for the provision of late night refreshment at different times, to those listed in the column on the left, please list</u></b> (please read guidance note 5)
Sat	12:00	00:00	
Sun			

**J**

<b>Supply of alcohol</b> Standard days and timings (please read guidance note 6)			<b><u>Will the supply of alcohol be for consumption (Please tick box)</u></b> (please read guidance note 7)	On the premises	<input checked="" type="checkbox"/>
				Off the premises	<input type="checkbox"/>
				Both	<input type="checkbox"/>
Day	Start	Finish	<b><u>State any seasonal variations for the supply of alcohol</u></b> (please read guidance note 4)		
Mon	12:00	23:00			
Tue	12:00	23:00			
Wed	12:00	23:00			
			<b><u>Non standard timings. Where you intend to use the premises for the supply of alcohol at different times to those listed in the column on the left, please list</u></b> (please read guidance note 5)		
Thur	12:00	23:00			
Fri	12:00	00:00			

Sat	12:00	00:00
Sun	12:00	23:00

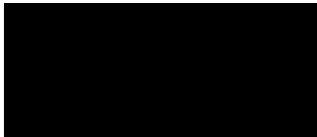
**State the name and details of the individual whom you wish to specify on the licence as designated premises supervisor:**

Name : Mr LloydPhilip	
Address 	
UK-England	
Postcode	
Personal licence number (if known)	
Issuing licensing authority (if known) Hackney	

**K**

**Please highlight any adult entertainment or services, activities, other entertainment or matters ancillary to the use of the premises that may give rise to concern in respect of children (please read guidance note 8).**

**L**



<b>Hours premises are open to the public</b> Standard timings (please read guidance note 6)			<b>State any seasonal variations</b> (please read guidance note 4)	
Day	Start	Finish		
Mon	12:00	23:00		
Tue	12:00	23:00		
Wed	12:00	23:00		
Thur	12:00	23:00		<b><u>Non standard timings. Where you intend the premises to be open to the public at different times from those listed in the column on the left, please list</u></b> (please read guidance note 5)
Fri	12:00	00:00		
Sat	10:00	00:00		
Sun	10:00	23:00		

**M** Describe the steps you intend to take to promote the four licensing objectives:

**a) General – all four licensing objectives (b,c,d,e)** (please read guidance note 9)

Hackney Historic Buildings Trust, the owners and operators of the Round Chapel exist to preserve and improve the fabric and structure of the chapel and St Augustine's Tower. In order to do this the trust raises money by hiring the chapel hall to private individuals, event companies and promoters. As a core policy the trust only hires out the building to reputable individuals and companies who have been vetted. It is our aim to provide a safe, welcoming environment to audiences who are attending events at the Round Chapel. We exist to protect the buildings in our care and therefore we do not allow any event where the audience are encouraged to become intoxicated or behave in a rowdy fashion - This will inevitably lead to damage to our listed building, annoyance to neighbours and an unwanted reputation. We have operated successfully and gained valuable experience operating under Temporary Events Notices and working with reputable hirers to operate low-key daytime and evening events.

**b) The prevention of crime and disorder**

Any provision of alcohol at events is ancillary to the event itself. Hirers must show that they will break-even or make a profit without the sale of alcohol and that the provision of alcohol is supplementary to the exhibition, performance or event programmed. Where a significant crowd is expected the Round Chapel insists on a high ratio of stewards and security personnel to effectively maintain orderly standards of behaviour both inside the hall and externally also.

Strict policies are in place regarding intoxication of the public and the prevention of drug-taking or drug dealing.

**c) Public safety**

We take the safety of our attendees very seriously. Hirers are inducted at the commencement of every event with regards to potential risk, health and safety policies, the fire management plan and evacuation procedures. Detailed risk assessments are carried out prior to events in conjunction with the hirer. Bar operators are reminded of their legal duties and the required duty of care they have in respect of the attending public.

**d) The prevention of public nuisance**

We are not a late night venue and all licensable activities cease at 11.00pm Sunday to Thursday and 12.00 midnight Friday and Saturday. The building and grounds are cleared in an efficient manner to ensure the safe and orderly dispersal of audiences.

**e) The protection of children from harm**

Children are only admitted to the building accompanied by an adult for matinee performances. Children are not permitted when alcohol is being served unless they are babes in arms.

**Checklist:**

**Please tick to indicate agreement**

- I have enclosed the plan of the premises.
- I have sent copies of this application and the plan to responsible authorities and  other  
s where applicable.
- I have enclosed the consent form completed by the individual I wish to be designated   
premises supervisor, if applicable.
- I understand that I must now advertise my application.
- I understand that if I do not comply with the above requirements my application will be

ted.

**IT IS AN OFFENCE, LIABLE ON SUMMARY CONVICTION TO A FINE NOT EXCEEDING LEVEL 5 ON THE STANDARD SCALE, UNDER SECTION 158 OF THE LICENSING ACT 2003, TO MAKE A FALSE STATEMENT IN OR IN CONNECTION WITH THIS APPLICATION.**

**Part 4 – Signatures** (please read guidance note 10)

**Signature of applicant or applicant’s solicitor or other duly authorised agent** (see guidance note 11). **If signing on behalf of the applicant, please state in what capacity.**

<b>Signature</b>	Philip Lloyd
<b>Date</b>	10/3/2016
<b>Capacity</b>	General Manager

**For joint applications, signature of 2<sup>nd</sup> applicant or 2<sup>nd</sup> applicant’s solicitor or other authorised agent** (please read guidance note 12). **If signing on behalf of the applicant, please state in what capacity.**

<b>Signature</b>	
<b>Date</b>	10/3/2016
<b>Capacity</b>	

Contact name (where not previously given) and postal address for correspondence associated with this application (please read guidance note 13)

**Premises Address**

UK-England

<b>Post town</b>		<b>Postcode</b>	
<b>Telephone number (if any)</b>			
If you would prefer us to correspond with you by e-mail, your e-mail address (optional)			

**Notes for Guidance**

1. Describe the premises, for example the type of premises, its general situation and layout and any other information which could be relevant to the licensing objectives. Where your application includes off-supplies of alcohol and you intend to provide a place for consumption of these off-supplies, you must include a description of where the place will be and its proximity to the premises.

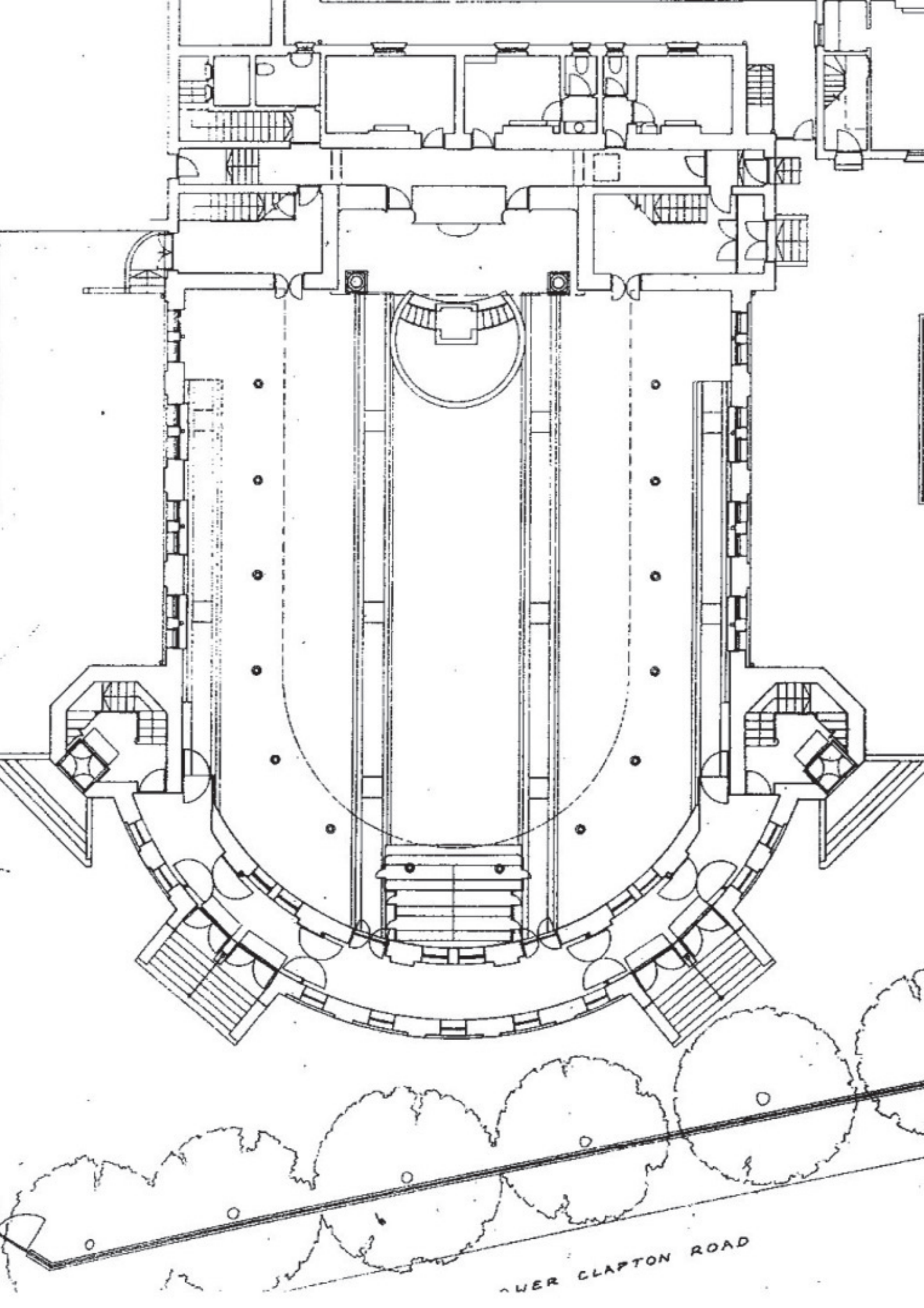

OWER CLAPTON ROAD

ON THE WALL

NO. 01 REVISED

**CAZENOVE**  
ARCHITECTS CO. OPERATIVE

NO. 300

THE ROUND CHAPEL  
LOWER CLAPTON E3

FOR  
M.H.B.T.

1118

GROUND FLOOR PLAN  
EXISTING

NO. 1:200

NO. 610/102

B

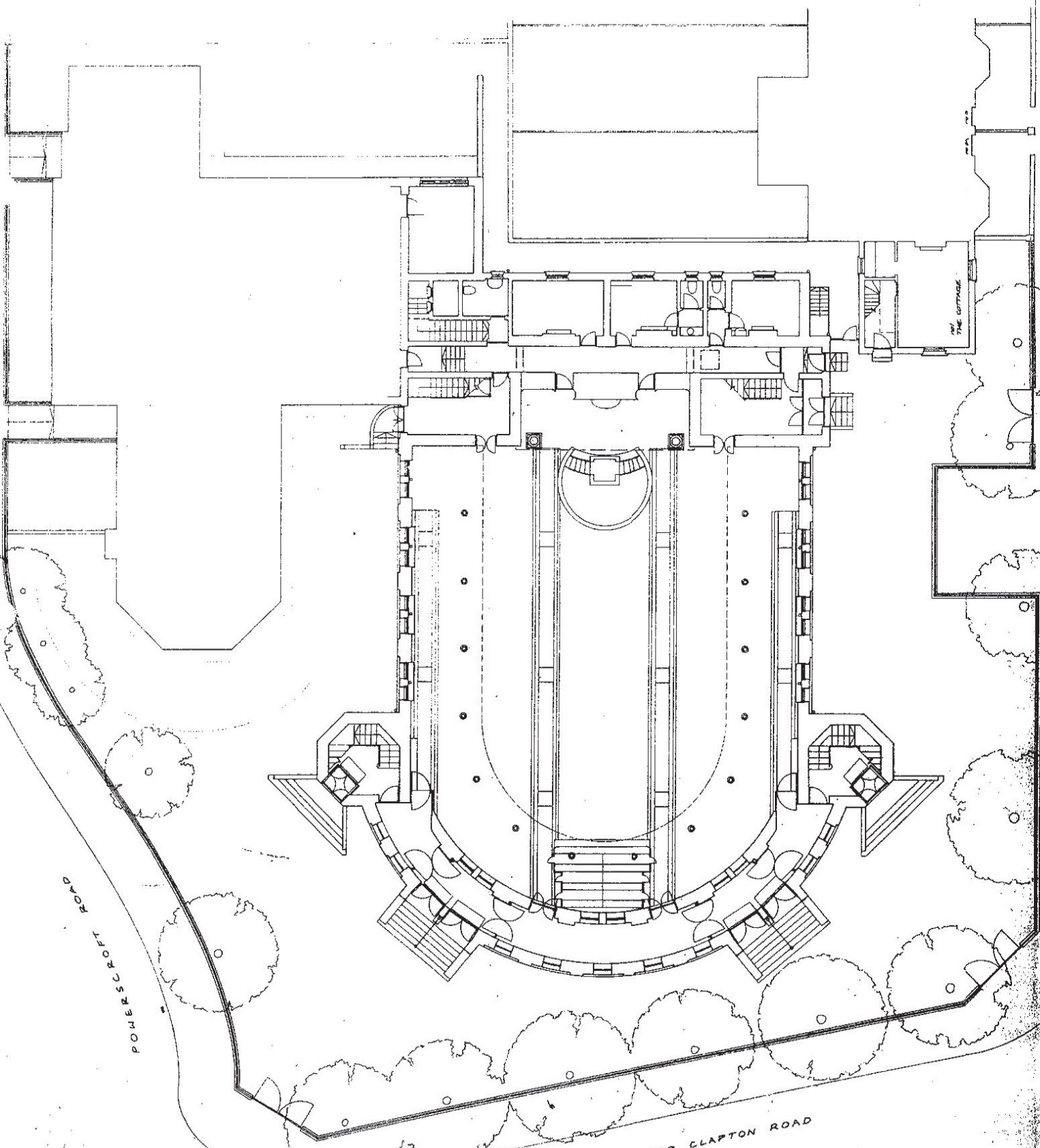
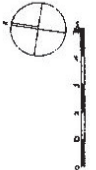

POWERS CROFT ROAD

LOWER CLAPTON ROAD

FIRST FLOOR,  
THE ROUND CHAPEL,  
LOWER GUAPTON RO

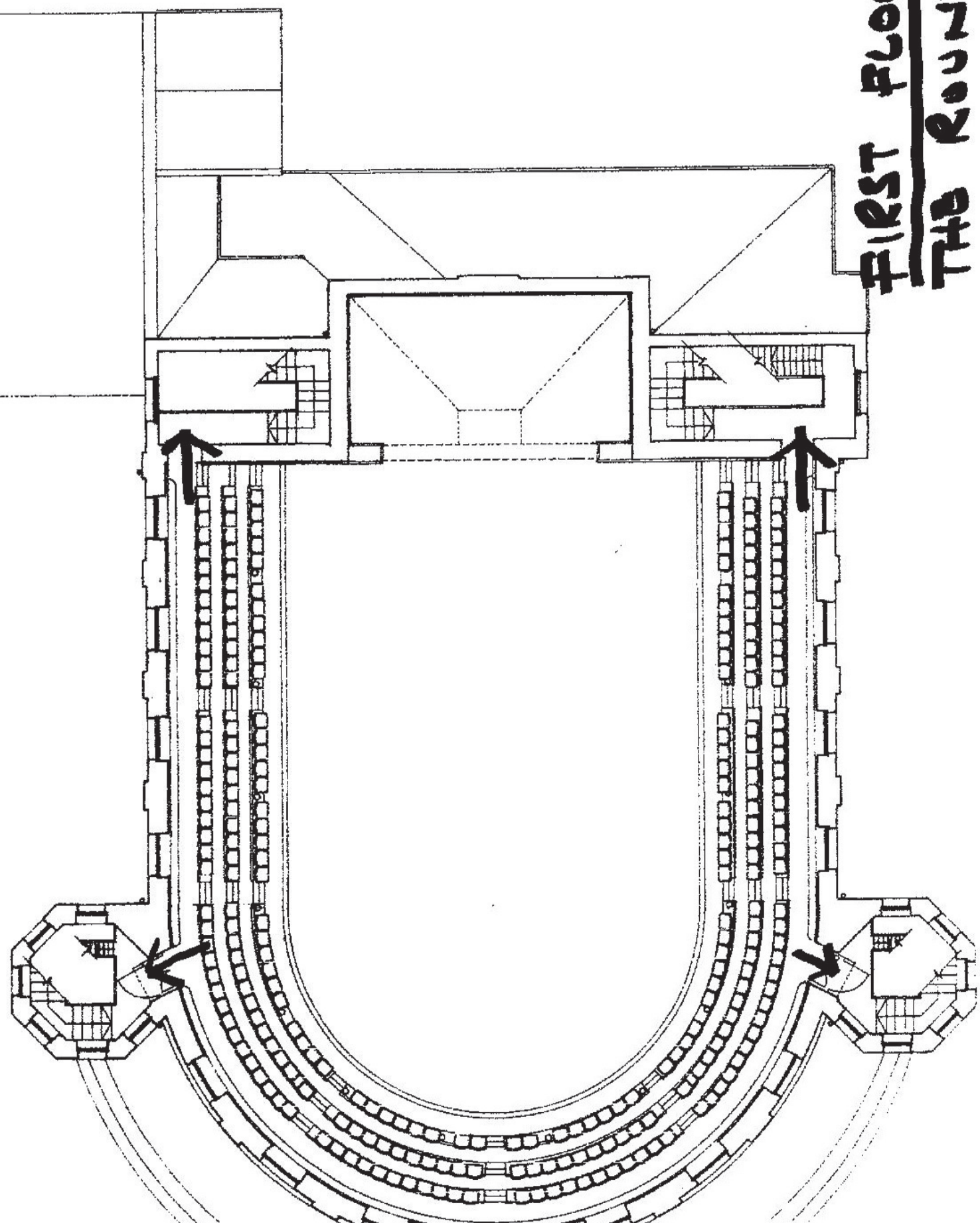



## **An Invitation from the Hackney Historic Buildings Trust to Discuss our Licensing Proposal for the Round Chapel**

**Dear Neighbours,**

**I expect you have heard about our application to have a Premises Licence at the Round Chapel and I know that some of you have written to the Council to express your concerns about it.**

**We have asked Hackney Council to defer considering the application for a licence so that we can meet local residents and we would like to invite you to a meeting at the Round Chapel on [May 24 at 7.00pm](#) when we can explain our plans and you can express any concerns you have about them. We would also like this to be an opportunity to hear about any other issues you have about the way we manage the premises so that we can do everything we can to be a good neighbour.**

**Clearly we need to explain ourselves better and listen to your concerns. From some of the comments made there may be some misunderstanding about what we are planning to do. As you probably know, our mission is to look after this building that we took over more than 20 years ago when its future was in doubt. It is a very expensive building to look after and we raise the money to do this by a wide variety of hires including concerts, weddings, meetings, memorial services, ceilidhs, film shoots and the annual Beer Festival.**

**Many of our hires such as the Hackney Schools Music Festival, the Vintage Fairs, weddings or wedding receptions do not require a premises license, The licensing proposal will make no difference to these events. We try to manage**

these events to prevent any anti-social behaviour but, if we are not doing as well as we should, then that is something we can and should discuss.

Licences are required for specific public events, generally where alcohol is sold. Over the last year events have included a wine tasting, and with a bar within the event, a jazz concert, a music festival, a ceilidh, and a film night, each ending at times between 5 pm and 11.30 pm. These require a licence called a Temporary Events Notice for each event.

We plan to continue with a similar range of events as a result of our getting a Premises Licence and we are definitely not extending our hours, or planning a nightclub. Indeed, as part of the proposed licence we have agreed with the Metropolitan Police that the bar will close 30 minutes before the end of each event. Having a Licence in place provides more certainty to attract new users such as the Royal Academy of Music for 6 nights in the Autumn, and the East London Comics and Arts Festival, and have less reliance on private events

At a different scale the Annual Pig's Ear Beer and Cider Festival in December has been a regular event over a number of years. We think that this is well managed by CAMRA but if there are any concerns, we would like to hear them. One last point to clear up is that we do not run the Hall in Powerscroft Road which is owned and managed by the Clapton Park United Reformed Church. We have also offered them an invitation to attend.

**We invite you to come and discuss these matters with us at the Round Chapel on Tuesday May 24th at 7.00pm**

If you cannot attend, or if you would like to discuss any concerns you have then you can contact us on [info@hhbt.org.uk](mailto:info@hhbt.org.uk) or 020 8986 0029.

**From Patrick Hammill,**

**Chair of Trustees**

Hackney Historic Buildings Trust  
1d Glenarm Road  
Hackney, London  
E5 OLY

Registered Charity No 291468  
Telephone: 0208 986 0029  
Email: [info@hhbt.org.uk](mailto:info@hhbt.org.uk)  
web: [roundchapel.org](http://roundchapel.org)



**HACKNEY HISTORIC BUILDINGS TRUST**  
**Note of Meeting the Neighbours meeting at the Round Chapel on Tuesday**  
**19.00-20.15 on 24<sup>th</sup> May 2016**

**Present**

[REDACTED]	HHBT Trustee
[REDACTED]	HHBT trustee
[REDACTED]	HHBT General Manager
[REDACTED]	United Reformed Church
[REDACTED]	6 Glenarm Road
[REDACTED]	3A Glenarm Road
[REDACTED]	15 Powerscroft Road
[REDACTED]	17 Powerscroft Road
[REDACTED]	17 Powerscroft Road
[REDACTED]	5A Glenarm Road
[REDACTED]	4 Glenarm Road
[REDACTED]	21 Powerscroft Road
[REDACTED]	13 Clapton Passage
[REDACTED]	1B Glenarm Road
[REDACTED]	25 Powerscroft Road

*(Background – a letter was distributed to the adjoining dwellings in nos 1 to 49 and 2 to 46 Glenarm Road and nos 1 – 67 and 4 -32a Powerscroft Road inviting them to this public meeting about the application for a licence. Copy attached)*

**Patrick** made the following points in opening about the way we run the Round Chapel at present:

- Hackney Historic Buildings Trust (which is non-profit-making) currently lets out the building for licensed events at the Round Chapel using the Temporary Event Notice (TENS) procedure, and for other events.
- Private parties or events, where alcohol is not sold to the public, do not require a licence
- Under the terms of our planning permission we are restricted in our hours of opening to 11.30pm Sunday to Thursday and 12.30am on Friday and Saturday

- Some events such as boxing (which has happened twice in the last year) and most public performances require either a TEN or a premises licence.
- For the Pigs Ear Beer Festival an application is made for a specific premises licence.
- Applying for a premises license is a blunt instrument, designed to cover all kinds of events, you tick the boxes and provide the information required. It does not reflect the way we wish to run the Round Chapel or our ambition of changing the types of uses with fewer private parties and more public performances by arts based organisations.

It is important to note that our application for a licence

- Will not alter or extend open hours. Indeed, events will close earlier than currently allowed and in addition it has been agreed with the local police that any bar will shut 30 mins before the end of licensed events.
- Will not result in the Round Chapel becoming a nightclub or a drinking venue. Indeed, it is a condition of the planning permission that the Round Chapel cannot be used as nightclub.
- It will also be a condition of the licence that all licensed events will have their costs covered by entry costs excluding drink sales, together with a duty to avoid sales that would lead to excess consumption of alcohol.
- Will result in better security measures including CCTV and SIA registered security personnel and (i.e. Security Industry Authority approved stewards) that will be required under the License.
- Will hopefully enable us to attract more business, particularly public performances, such as the forthcoming Royal Academy of Music event (two weeks rehearsal/preparation and 6 nights of public performances finishing earlier) and reduce HHBT's dependence on bookings for private parties,
- Will reduce costs and paperwork for HHBT as it avoids the need to make separate application for each licensed event.

Patrick explained how the HHBT operates. It has owned and run the Round Chapel since 1995 which it acquired the building from the United Reformed Church. The Old School Rooms on the Powerscroft Road remains in the ownership of the URC.

HHBT hires out the Hall for a wide variety of events to raise funds to maintain and repair the church and after 20 years there are some serious costs building

up. There is a very wide variety of events including the Hackney Schools Music Festival, the Beer Festival, filming (e.g. Halifax advertisement) and film nights, memorial services, civil weddings, and wedding parties.

There is intensive use on Fridays and (particularly) Saturdays and under-use during weekdays and weekday evenings: broadly 90% weekend bookings and only 10% during Monday to Thursday. HHBT would like to alter the mix with more ticketed performance type of events which finish earlier and with the doors being open to the wider community.

██████ said the main problem was that people hung around well after events finished. If an event finishes at 12 people may not leave till 1. He would like to see private events finishing earlier.

██████ said that drunken people create problems dispersing drink, pee and vomit in Powerscroft Road, and especially in her front garden. It was agreed that the problem was much worse in Powerscroft than Glenarm as far more people seem to walk that way.

██████ said that the problem is worse in summer months when people congregate out at the front and make noise.

██████ said that licensing of itself would make this problem less not greater. The bar would be closed 30 mins before the allowable time and there would be CCTV and door staff to watch over behaviour in the gravel area at the front of the Round Chapel.

██████ said that he was supportive of the Round Chapel and of the licence but the concern is that noise goes on well after the bars closed.

After more contributions there was agreement that most of the difficulties are around the dispersal of people at the end of events and that many of the problems really arise from wedding and other private parties which are not licensed.

██████ explained that if licensed business, such as concerts, replace wedding parties, it should alleviate the problem as those events often finish earlier in the evening. HHBT has been told that the Royal Academy of Music performances will finish at 10.

That said, there was agreement that, irrespective of the licensing issue, HHBT should look very carefully at how we can manage events, especially parties, to minimise noise at the end of events.

██████ said that HHBT has made a start by recruiting Duty Managers with a specific stewarding role in place of caretakers. HHBT is paying them more, reflecting the fact that more is expected of them.

In addition, since appointed he has been at the conclusion of a number of events to ensure they close on time and people disperse. This oversight will continue with monitoring from Philip and Trustees.

HHBT would be able to adopt a policy of closing the gates promptly after an event as a way of shepherding people off the premises earlier and encouraging them to disperse.

HHBT will also consider increased stewarding for specific events to manage the dispersal issue.

██████ made the point that not all the disturbance blamed on the Round Chapel is associated with Round Chapel activities/events. There had been a very recent complaint from ████████ (Glenarm Road) of late night music but that had been due to some youths who had parked up their car and played amplified music.

It was agreed that issues could be better nipped in the bud if there was communication when problems arise. HHBT e-mail contact details had been circulated to everyone present and HHBT would do its best to respond when issues are raised. ████████ mentioned that our previous manager, Lisa, had said there had been very few complaints indeed in past years.

██████ confirmed that hirers pay a forfeitable deposit (£500). This is most often forfeited when hirers stay longer than contracted hours or fail to clear up adequately. If well-founded complaints by neighbours about after-hours disturbance are communicated promptly this might lead to more cases of forfeiting.

██████ said that it would relieve some stress on the building if HHBT could have more “non-event” weekends to enable maintenance tasks such as re-sanding the floor to go on. A better mix would help us to do this, though this will happen over time.

There was discussion about noise issues associated with the “URC side” on Powerscroft Road. The main concern was about amplified music early on Sunday morning. █████ asked that the issue be raised with the Minister and Elders, and that maybe the URC could also host a “meet the neighbours” session. █████ said he would do so and readily agreed that his contact details be added to the circulation list so that people could get in touch.

There was discussion about parking. █████ said that HHBT general terms of business provide 4 parking spaces, intended for disabled drivers or visitors, and that all our information for hirers lays great emphasis on the excellent public transport and that we always encourage people to use it. He accepted that the lack of on-site parking meant visitor/drivers might park around local streets. The problem is worse on the Glenarm Road side with on occasion people blocking the turnaround space. █████ said that ‘satnavs’ use the Round Chapel postcode to direct drivers to Glenarm Road; he is working to get this corrected, to direct people to Lower Clapton Road. There was some feeling that the increase in the ‘Night Time Economy’ in Lower Clapton Road (the Round Chapel is only a part of this) reinforced a case for extending the hours of parking controls, c.f. Hackney Central around the Empire where 11.00pm is current. The Council should be contacted, preferably by local residents/Residents’ Association, if a change is thought useful. HHBT would support any request to extend the controlled parking hours around the Round Chapel.

█████ and others wondered whether the premises licence could be limited in time to one year so that the impact could be observed by neighbours. Patrick thought that the period of the licence was 2 years and that there would then have to be fresh application. However, HHBT Trustees would look into the length of licence and would be happy to meet residents on a regular basis to ensure that all was well, initially every 6 months was proposed.

█████ was also concerned that the license could be transferred to another holder at a later date. Patrick confirmed that the License is specific to the HHBT.

Many people said they were enthusiastic supporters of the Round Chapel and would like to know more about what was going on. Philip said that everyone who had attended the meeting would be put on the mailing list of events. HHBT would also raise with organisers of hiring for performance events whether reduced price or free tickets could be offered to local residents/neighbours.

██████ thanked everyone for coming and so clearly explaining their points of view; he hoped we would maintain contact. Everyone agreed that notes should be circulated with e-mail addresses so that neighbours could keep in contact with each other.

## **The Round Chapel Lower Clapton Road Application for a License**

*Responding to Resident's Concern.*

*Raised by residents at the public meeting or in the Representations*

*1. The license will increase the hours of opening.*

Current hours are until 11.30pm Sunday to Thursday, 12.30am Friday and Saturday

The proposed license hours will close earlier, NOT later : 11.00 Sunday to Thursday, 12.00midnight Friday and Saturday.

The bar will close 30 minutes earlier, 10.30 Sunday to Thursday, 11.30 Friday and Saturday. (Agreed with Met Police.)

*2. People hang around the front area before leaving, creating noise and disturbance.*

Under the License SIA approved stewards will be employed on the door and managing the front area will be included in their job description to clear the area, ask people to leave quietly, and shut the gates promptly after an event.

Notices will be fixed at the exit doors to remind people leaving that this is a residential area, and asking them to please leave quietly (Met Police condition), we will also put these notices by the gates.

*3People will take their drinks outside on a warm summers day.*

Taking alcohol outside is not permitted by the Met Police conditions.

*4. People misbehave after leaving the building, causing noise, vomiting and urinating in the adjoining street.*

It is not clear that these instances are from people leaving the Round Chapel. We do not dispute that they happen and cause serious distress to residents. There are conditions attached to the license to ensure that the people responsible for any alcohol sales must not encourage excessive drinking. We are happy to strengthen that condition within our terms of hire to ensure alcohol is not served to any individual who may be seen to be consuming to much.

*5. Will there be more events under the license than now?*

Most events are booked for the weekends. That is unlikely to change. We are not planning for a significant increase in use but because of the license to attract different users that will pay more and encourage access for the local community..

*6. Noise can sometimes 'leak' out of the building and cause nuisance to close neighbours.*

HHBT will be employing Duty Managers for events, trained in managing events, they will be equipped with a noise meter and their tasks will include monitoring and controlling noise levels, including patrolling externally. Officers from Hackney Council Environmental Team have inspected the building and taken noise tests and have no objections to the uses proposed.

*7. Parking . due to the lack of parking at the Round Chapel users parked in Glenarm Road and Powerscroft Road and the adjoining area, causing problems for residents.*

The Round Chapel website is clear about the lack of parking and recommends the use of public transport, with detailed information set out. The HHBT is happy to work with residents to have the hours of the CPZ increased, possibly to the 11.00pm around the Hackney Empire.

*8. There has been a separate query about the proposed license for boxing and/or wrestling.*

Over the last few years there have been one or two wrestling/martial arts events each year. We are not aiming to increase this market.

*9. There has been a representation based on the assumption that 'a late night bar/drinking destination' or 'nightclub' will be created.*

The Round Chapel will not become 'a late night bar/drinking destination. All events will be ticketed, and the promoters will need to demonstrate that the event is viable from ticket sales alone, rather than the need to sell alcohol.

Under the terms of the planning permission for the Round Chapel, use as a nightclub is not permitted.

*10. Other concerns were that granting a license will lead to further nuisance locally.*

See the first point above noting that the hours will be reduced rather than extended.

Resolving problems

The contact details for the HHBT have been passed to residents so that if there were problems they could be brought to the Trusts attention promptly, and it was agreed that there would be a follow up meeting in 6 months time.



# APPENDIX B1

## RESPONSIBLE AUTHORITY REPRESENTATION: APPLICATION UNDER THE LICENSING ACT 2003

### RESPONSIBLE AUTHORITY DETAILS

NAME OF AUTHORITY	Licensing
ADDRESS OF AUTHORITY	Licensing Service Legal, HR and Regulatory Services Directorate 2 Hillman St London E8 1FB
CONTACT NAME	Darren Reilly
TELEPHONE NUMBER	020 8356 4965
E-MAIL ADDRESS	darren.reilly@hackney.gov.uk

### APPLICATION PREMISES

NAME & ADDRESS OF PREMISES	<b>The Round Chapel Arts Centre The Round Chapel 1D Glenarm Road Hackney London E5 0LY</b>
NAME OF APPLICANT/PREMISES USER	<b>Hackney Historic Building Trust</b>

### COMMENTS

I make the following relevant representations in relation to the above application.

- 1) the prevention of crime and disorder
- 2) public safety
- 3) the prevention of public nuisance x
- 4) the protection of children from harm

Representations (which include comments and/or objections) in relation to:

The premises is located in a residential area and licensing have concerns about the potential for public nuisance should the licence be granted. There are particular concerns given the nature of the building.

Applicant should contact licensing to discuss whether changes to the application and/or conditions being added may allay concerns and lead to agreement.

The above representations are supported by the following evidence and information.

The licensing Policy and Licensing Objectives

Are there any actions or measures that could be taken to allay concerns or objections? If so, please explain.

Applicant should contact licensing to discuss

Name: Darren Reilly (Team Leader Licensing Enforcement)

Date: 13/4/16

# APPENDIX B2

## RESPONSIBLE AUTHORITY REPRESENTATION: APPLICATION UNDER THE LICENSING ACT 2003

### RESPONSIBLE AUTHORITY DETAILS

ref:076975

NAME OF AUTHORITY	Environmental Health (Environmental Enforcement)
ADDRESS OF AUTHORITY	Keltan House, 89-115 Mare Street, London E8 4RU
CONTACT NAME	Patrizia Valpondi
TELEPHONE NUMBER	0208 356 5263
E-MAIL ADDRESS	patrizia.valpondi@hackney.gov.uk

### APPLICATION PREMISES

NAME & ADDRESS OF PREMISES	Round Chapel Arts Centre The Round Chapel 1D Glenarm Road Hackney London E5 0LY
NAME OF PREMISES USER	Mr Lloyd Philip

### COMMENTS

I make the following relevant representations in relation to the above application in respect of licensable activities.

- |    |                                      |   |
|----|--------------------------------------|---|
| 1) | the prevention of crime and disorder |   |
| 2) | public safety                        | X |
| 3) | the prevention of public nuisance    | X |
| 4) | the protection of children from harm |   |

Representations (which include comments and/or objections) in relation to:

**ENVIRONMENTAL LICENCE CONDITIONS IN RESPECT OF**  
**Mrs Lloyd Philip**  
**Round Chapel Arts Centre**  
Businesses have a legal requirement to ensure that they have adequate arrangements in place for the storage and disposal of waste generated by the business. Also there should be measures put in place to prevent littering to the detriment of the area.

The above representations are supported by the following evidence and information.

**Information and Evidence** – we have received complaints in the past regarding littering and build-up of waste in the area, and there is no reference as to its waste storage and collection arrangements and consequential environmental impact. The Council holds no records in relation to the waste disposal arrangements at these premises  
Experience has also shown that there is the probability that there will be cigarette litter outside these premises due to the smoking ban and that it is possible that glasses and bottles may be left outside by patrons.

Are there any actions or measures that could be taken to allay concerns or objections? If so, please explain.

Applicant should contact **Patrizia Valpondi** by phone or email, to discuss some conditions which could allay our concerns.

Signed [patrizia.valpondi@hackney.gov.uk](mailto:patrizia.valpondi@hackney.gov.uk)

Name Patrizia Valpondi

Phone 0208356526

**From:** [REDACTED]  
**Sent:** 12 April 2016 09:41  
**To:** Licensing  
**Subject:** Round Chapel

Extending the hours during weekdays is not acceptable to local residents who already put up with the noise and disruption caused by events at the Round Chapel. Residents of Powerscroft Road and Glenarm Road have been exceptionally tolerant of the Round Chapel's activities and extending the hours would have too much of an impact on residents. It should also be taken into account that many of us have young children who are often kept awake as it is.

[REDACTED]

# APPENDIX C2

Mike Smith

---

**From:** [REDACTED]  
**Sent:** 12 April 2016 08:26  
**To:** Licensing  
**Subject:** Lower Clapton road

Hello

We've become aware of the application for a midnight license at the round chapel on lower Clapton road and would like to object.

It's likely to create a Public nuisance and disorder on Lower Clapton road. Becoming a late night bar / drinking destination similar to Dalston would come at a cost to local residence. Our house is within ear shot of the church and the kick out time would mean we get lots of noise, rubbish and sick on the street. Shouting late at night already happens on our street and any increase will be even harder to tolerate. Lower Clapton road should not become a night life destination.

Im sure you're aware that amplified church singing starts at 8am on Sunday so there is little enough respite as it is, without extending its license into the evening.

Regards

[REDACTED]  
[REDACTED] Linscott road  
London  
E: [REDACTED]

**From:** [REDACTED]  
**Sent:** 12 April 2016 08:08  
**To:** Licensing  
**Subject:** The Round Chapel, E5

Dear Licensing Team,

There is a notice placed on a tree in the grounds of the Round Chapel with detail of a new/renewal to a Premises License, and I would like to object to the extension of hours for the sale of alcohol at weekends contained in this until midnight.

While the venue is a great community resource, the impact on the immediate neighbours is also quite high.

We have appealed to the Vicar and HHBT to be good neighbours and limit the time of more lively events so the effect on neighbours late at night is limited. Ideally this would be the sale of alcohol finishing at 10pm, so the spill out is over by 11pm.

The effect of 'happy' people leaving late at night and saying goodbye to friends, slamming car doors etc has resulted in several complaints to your EH colleagues. Additionally on occasion the use of exceptionally loud PA systems has also made life in the neighbourhood unpleasant, and resulted in complaints to the Council.

The fact the venue has no parking, no apparent travel plan, and the local CPZ does not operate at evenings and weekends means the parking on the local streets exacerbates this.

I hope you will reconsider the application.

Yours

[REDACTED]  
[REDACTED] Powerscroft Rd  
E5 [REDACTED]

From: [REDACTED]  
Sent: 12 April 2016 05:47  
To: Licensing

To whom it may concern,

I'm writing to make a representation and objection to the license application for:

*The Round Chapel 1D Glenarm Road London E5 0LY*

*Lea Bridge Hackney*

*Histotric Buildings Trust Application for a premises licence to allow the supply of alcohol, plays, films, indoor sporting events, boxing or wrestling, live music, recorded music, performances of dance and any entertainment of a similar description from 12:00 to 23:00 Sun to Thurs and 12:00 to 00:00 Fri and Sat and late night refreshment from 23:00 to 00:00 Fri and Sat.*

*Closing date: 13/04/2016*

The extension of drinking and entertainment hours of the Round Chapel on weekdays to 23.00 and Fri and Sat to 00.00 will create a serious and life changing public nuisance for us.

The noise from the Round Chapel seriously affects our families well being. We have a young family and are up very early each morning. Our bedroom and living space is at the front of the house and we are seriously disturbed by both the noise of the music bass and then the disorder follow kick out time with drunk and disorderly behavior. We can hear the bass in our rooms, often get after hours shouting outside our windows and vomit at our gate or on our car parked outside, which my children have to step over on their way to nursery and school.

The late night music and kick out time disorder always lasts half an hour after closure and prevents us getting a full nights sleep and really affects our well being, this is two fold during the summer months when there are parties every Thu - Sun night.

The bass and music amplification then also starts up again on a Sunday mornings at 8am with the Round Chapel church starting their highly amplified Sunday church bass music. Extending the hours is really causing us extreme anxiety as we are already very disturbed by both the late night parties and the Sunday morning music and feel we can't get any peace.

I have already emailed complaints to Hackney pollution support team and had visits from Peter Show to try and resolve the existing problems. Extending the hours will only make these existing problems worse.

This is a residential area and a great community, with lots of young families on both Powerscroft and Glenarm road and we need to prevent public nuisance extending later into the evenings and disturbing the residents.

Looking forward to receiving your consultation.

[REDACTED]  
Powerscroft Rd  
E5 [REDACTED]  
[REDACTED]



**From:** [REDACTED]  
**Sent:** 11 April 2016 11:38  
**To:** Licensing  
**Subject:** Round Chapel

Dear Sir / Madam

I'm writing to strongly object about the possible licence to serve alcohol until Midnight at the round chapel venue.

I'm a resident of Powerscroft Road and my main objection will be noise as its already very noisy when there are functions there and if the licence was granted... Instead of the functions coming to a natural close by about 11.45pm it would end up being closer to 1am which is unacceptable in a residential area where young children which I have two are trying to sleep.

I would like to be kept informed of any process going forward to object to this licence being granted.

Kind regards

**From:** [REDACTED]  
**Sent:** 10 April 2016 20:49  
**To:** Licensing  
**Subject:** License Request for Round Chapel

Dear Sir.Madam,.

I am writing to object to the application for a license extension for the Round Chapel. I live opposite and over many years have experienced the inconvenience of many events which have resulted in unreasonable levels of noise and anti social behaviour. Often when events finish it will be at least an hour or more before all those attending events disperse resulting in high levels of noise.

I would therefore ask that the license is not extended to cause further noise disruption late at night in a residential area.

Yours faithfully

[REDACTED]  
[REDACTED] Powerscroft Rd  
Hackney  
London  
E5 [REDACTED]

Mike Smith

---

**From:** [REDACTED]  
**Sent:** 10 April 2016 13:55  
**To:** Licensing  
**Cc:** [REDACTED]  
**Subject:** Round Chapel licensing application

Dear Hackney Licensing

We are writing to express our strong objection to the proposed hours of operation of the licensing application submitted by Hackney Historic Buildings Trust for the Round Chapel, 1a Glenarm Road.

We live on Powerscroft Road, near the Round Chapel. While we fully support this wonderful building being more fully used for community, arts or other popular events, this must be balanced with the needs of local residents. Noise from events from the Round Chapel is clearly heard in our houses and gardens both during the events and often for some considerable time afterwards as visitors leave the building and walk along the street to their cars or to catch the bus, often causing quite a lot of noise and nuisance (leaving rubbish, urinating etc) We therefore think that a closing time of 12 midnight at weekends is too late and that this should be kept at 11 pm. This is primarily a residential neighbourhood with families with young children and residents needs must be taken into account. Such a late closure would in our view likely result in a public nuisance.

We already have a long-running struggle with the church at the neighbouring building who cause a noise disturbance on Sunday mornings. Council officers have been aware of this.

Best wishes

[REDACTED]

[REDACTED] Powerscroft Road  
London [REDACTED]  
[REDACTED]

# APPENDIX D

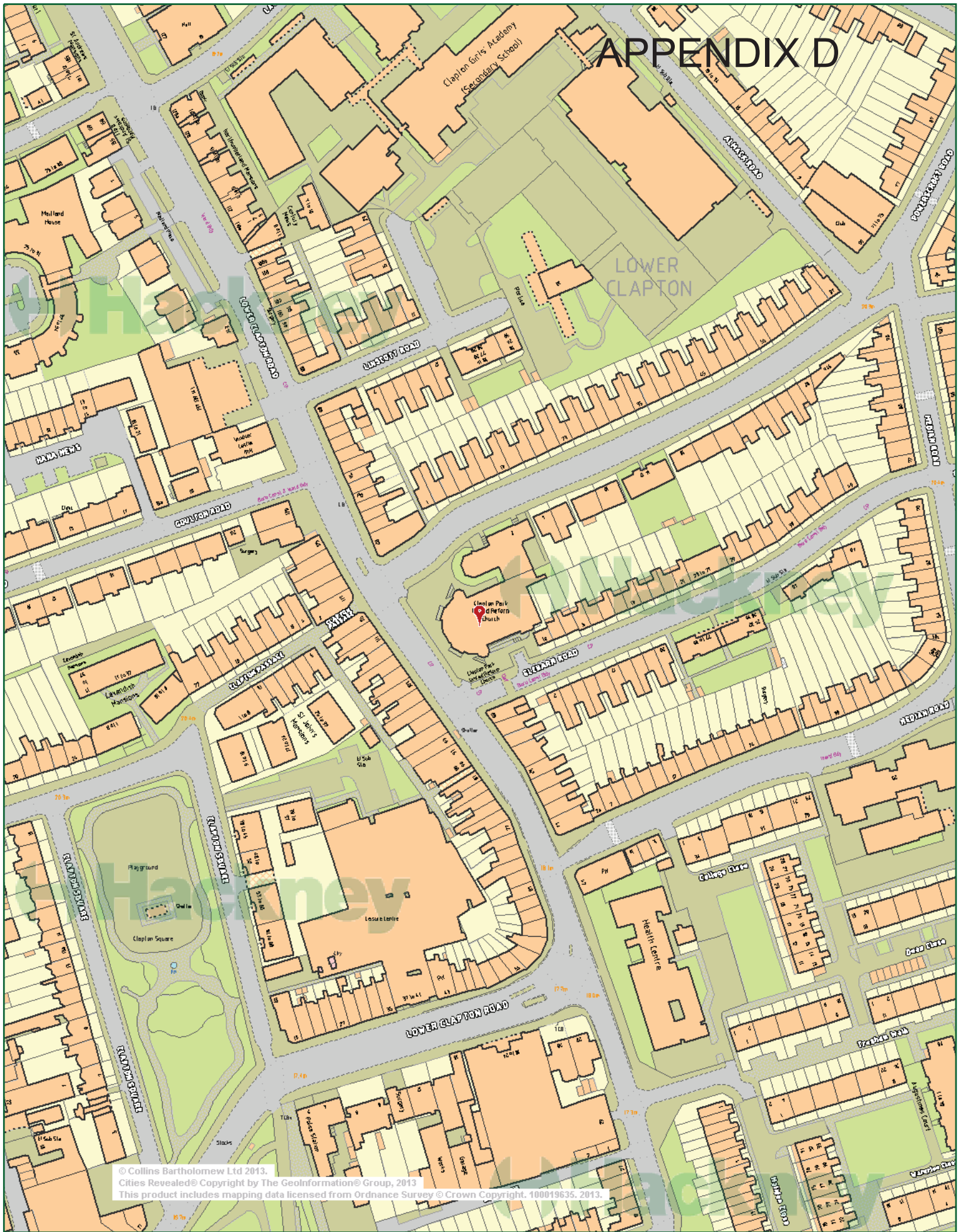

© Collins Bartholomew Ltd 2013.  
Cities Revealed© Copyright by The GeoInformation© Group, 2013  
This product includes mapping data licensed from Ordnance Survey © Crown Copyright, 100019635, 2013.



Round Chapel

Scale 1/1894

at A4



Date 26/4/2016



© Collins Bartholomew

This product includes mapping data licensed from Ordnance Survey with the permission of HMSO © Crown Copyright 2011. All rights reserved. License number. 100019635, 2011

©Bartholomew Ltd.Reproduced by permission, Harper Collins Publishers 2010

Cities Revealed© Copyright by The GeoInformation© Group, 2010